

Parts Molding Process for Home Appliances

Usage A device that bends a copper shaft used in home appliance parts by pressing it against a mold.

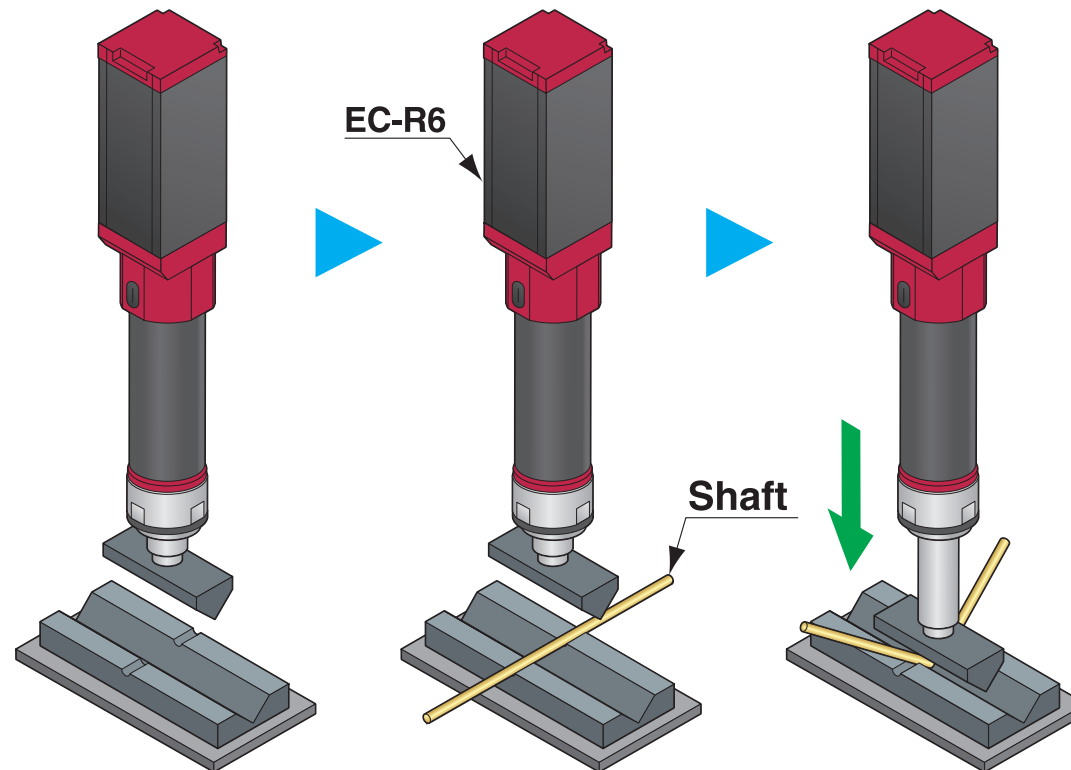

Explanation Conventionally, an air cylinder was used for the bending process, but by switching to Elecylinder, it can now operate in low speed as well, and stabilize the pressure exerted, which eliminates warping and burrs, resulting in consistent product quality.